

BODY WORN CAMERA User Manual



Safety Instruction

These instructions are intended to ensure that user can use our product correctly to avoid danger or property loss.

⚠️ Cautions: Injury or equipment damage may occur if any of cautions are neglected.

- Proper configuration of all passwords are the responsibility of the installer and/or end-user.
- In the use of the product, you must be in strict compliance with the electrical safety regulations of the nation and region.
- Input voltage should meet both the Safety Extra Low Voltage and the Limited Power Source with 5V DC.
- Please make sure that the plug is firmly connected to the power socket.
- If smoke, odor or noise rise from the device, turn off the power at once and unplug the power cable, and then please contact the service center.

Preventive and Cautionary Tips

Before operating your device, please be advised of the following tips:

- Do not store the product in high-temperature or damp environment, and do not expose it to high electromagnetic radiation.
- If the product does not function properly, please contact your dealer. Do not disassemble the product for repair or maintenance by yourself.
- Only use the battery, power adapter and accessories provided by the manufacturer.
- Consult the authorized dealer for any question and request for product using.

Chapter 1 Introduction

Body-worn Camera is the wearable camera incorporating an audio and video recording. This camera is designed for the use in law enforcement, and security activities to record the truth that agencies need to build transparency and accountability with the public.

1.1 Overview



Table 1.1 Button & Switch

Name	Description
Slide Switch	Simply slide the switch down to start capturing video, slide the switch up to stop and save video.
Push to talk(PTT)	Hold the PTT Button to send out message, release to copy.
Snapshot	a. Press it to shoot a still photo. b. Hold it for 3 seconds to start audio recording.
Important Tag	a. Press it to mark evidence with important tag. b. Hold it for 3 seconds to activate LED white light.
Power	a. Hold it for 3 seconds to power on/off. b. Press it to turn on/off screen.
Menu	a. Access to menu mode. b. Return.
Confirm/Pause	a. Confirm your option. b. Pause while playing back video.

Table 1.2 LED Color

Mode	LED Indicator
Video Recording	Blinking Red
Audio Recording	Blinking Yellow
Standby/Pre-rec.	Solid Green
Error*	Solid Red

1.2 Mounting Accessories Installation

The mounting accessories include the panel and clip.

Installation Step:

1. Install the panel on the camera, ensure the camera is completely inserted into the panel.
2. Push the clip onto the top of the mounting slot on the panel according to below direction, slide the clip to the correct position, a click sound will be heard when it's done.

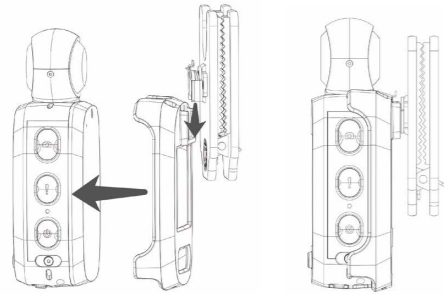

1.3 Camera Articulation

The camera head is able to rotate horizontally within limits. However, **DO NOT OVER ROTATE!** The camera head does not rotate 360 degrees, forcing it will cause damage to the camera head.

1.4 Charging

Power Charger Specification:

Input: 100 ~ 240 V AC, 50/60 Hz. Output: 5 V/2.0 A.

“**Low battery**” shown on the screen if insufficient power, please follow below instruction for power charging.

Steps:

- a. Open the cover of USB.
- b. Connect Body-worn Camera to the charger with USB cable.

Chapter 2 Operation

2.1 Power-on/off

Turn on the device by holding the Power Button for three seconds, when you hear a sound notification, it means the Body-worn camera starts up successfully. Hold the Power Button for three seconds again to power off.

2.2 Menu

After the Body-worn camera starts up, it enters into the preview mode automatically. Press the Menu Button to enter into Menu mode.

2.3 Connecting the PTT Cable (Optional)

Connect the Body-worn Camera to Walkie & Talkie with designated PTT cable as a speaker microphone. Hold the PTT Button to send out message, release to copy.



Notes:

Skip this section if you do not purchase the PTT Cable.

2.4 Video Recording

Record the video in crime scenes or other situations.

Steps:

- a. The camera does not need to be powered on to start recording. Simply slide the switch down to start capturing video, the LED indicator starts flashing in red.
- b. Optionally, during the video recording, you can press the Snapshot Button to capture current live view image. Or you can press the Important Tag Button to mark the video as an “IMPORTANT EVIDENCE”.
- c. Slide the switch up to stop and save video.

2.5 Snapshot

You can take pictures of the crime scenes or other situations in using Body-worn Camera, simply press Snapshot Button to take a picture.

2.6 Audio Recording

You can choose to only record the audio.

Steps:

- a. Hold the Snapshot Button for 3 seconds to start audio recording.
- b. Hold the Button again to end recording.

2.7 Playback

Press Menu to enter into Menu Mode - Playback - Video/Audio/Photo.

Notes: You can fast forward or rewind with left/right Button.

2.8 Pre-event Recording

Steps:

- a. Menu Mode - Preference - Pre Recording - On/Off.
- b. If you activated the Pre-record function, when you start recording at 10:00, the camera records it at 9:59:30 automatically.

2.9 AES 256

Once AES 256 has been activated, all data on your camera will be encrypted. It's strongly recommended to turn it off if you do not have Docking Station.

2.10 Stealth Mode

For some situations, you may wish to turn off the LED lights, sounds (audio prompts) on your camera. Turning off all the indicators and notifications is also known as stealth mode.

Steps: Menu Mode - System - Stealth Mode.

Warranty Card

Product Name	
Purchase Date	
Description	
Name	
Mobile	
Email	
Address	